

NATURAL 2

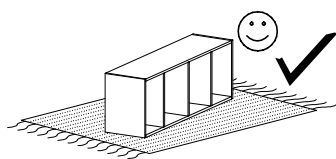

Narzędzia potrzebne do montażu

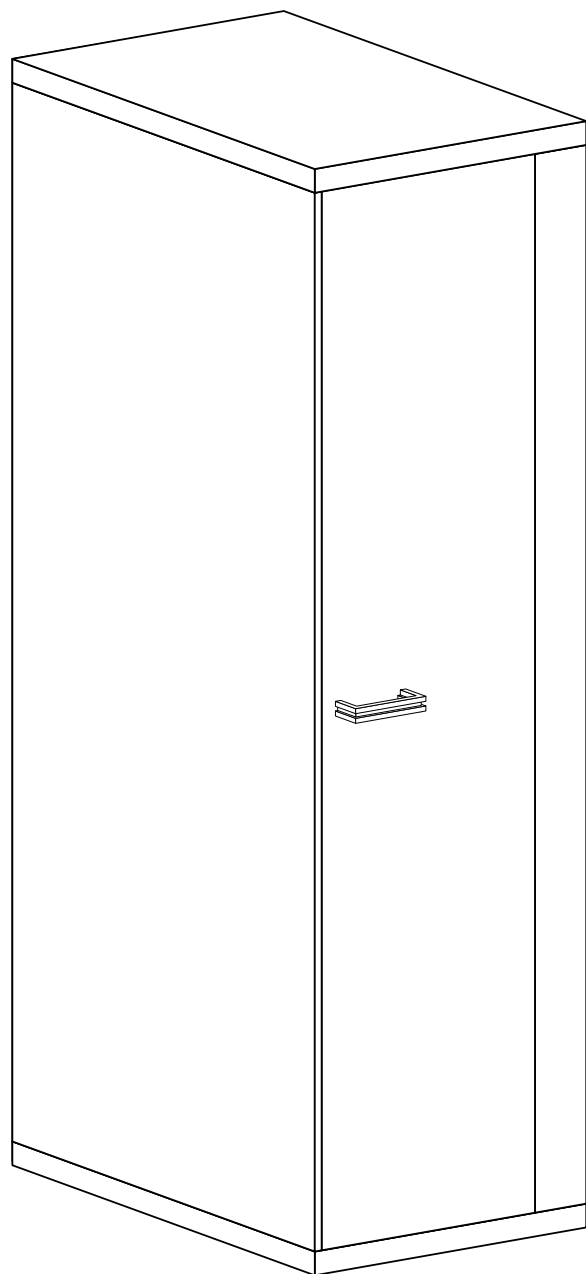

Nr	D[mm]	S[mm]	G[mm]	Ilość
1	1900	576	16	1
2	1950	560	16	1
3	578	568	48	1
4	578	568	48	1
5	560	535	16	1
6	1950	100	16	1
7	1950	560	2,5	1
8	1894	445	16	1

UWAGA !!!

MONTOWANIE USZKODZONYCH
ELEMENTÓW POWODUJE UTRATĘ
GWARANCJI

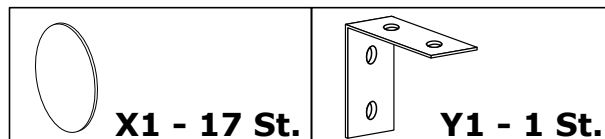

X1 - 17 St.

Y1 - 1 St.

UWAGA !!!

Mebel zawiera
elementy drewniane

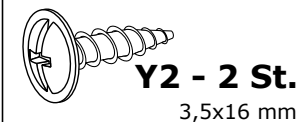

Y2 - 2 St.
3,5x16 mm



A - 1 St.

W przypadku reklamacji proszę podać numer pakowacza znajdujący się na kartonie.

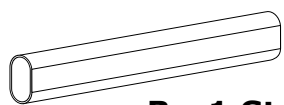

B - 1 St.

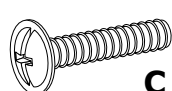

C - 2 St.
4x22 mm

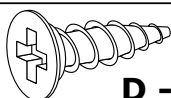

D - 12 St.
3,5x16 mm

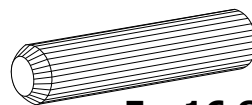

E - 16 St.

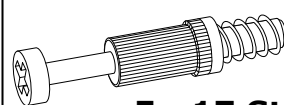

F - 17 St.

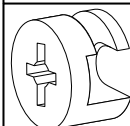

G - 17 St.



H - 2 St.



I - 60 St.

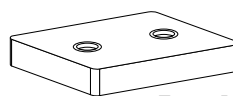

J - 4 St.

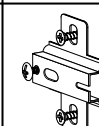

K - 3 St.

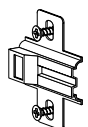

L - 1 St.

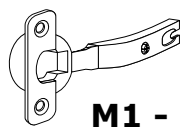

M1 - 3 St.

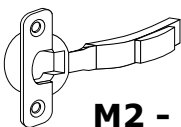

M2 - 1 St.

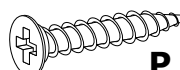

P - 8 St.
3,5x25 mm

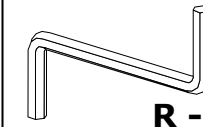

R - 1 St.

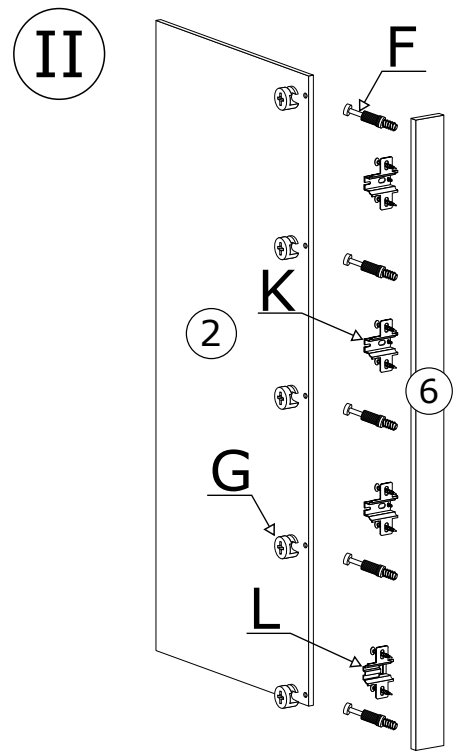
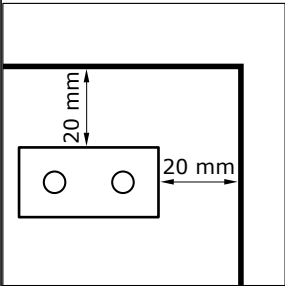
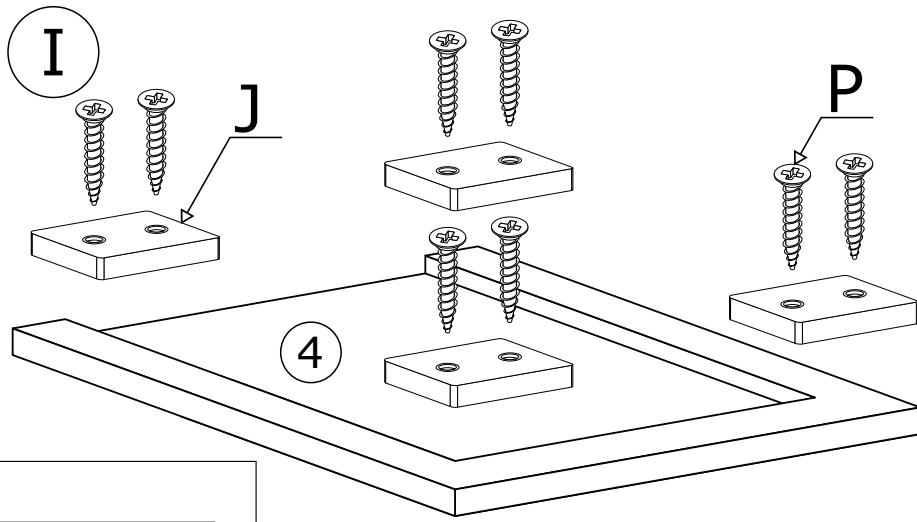

III

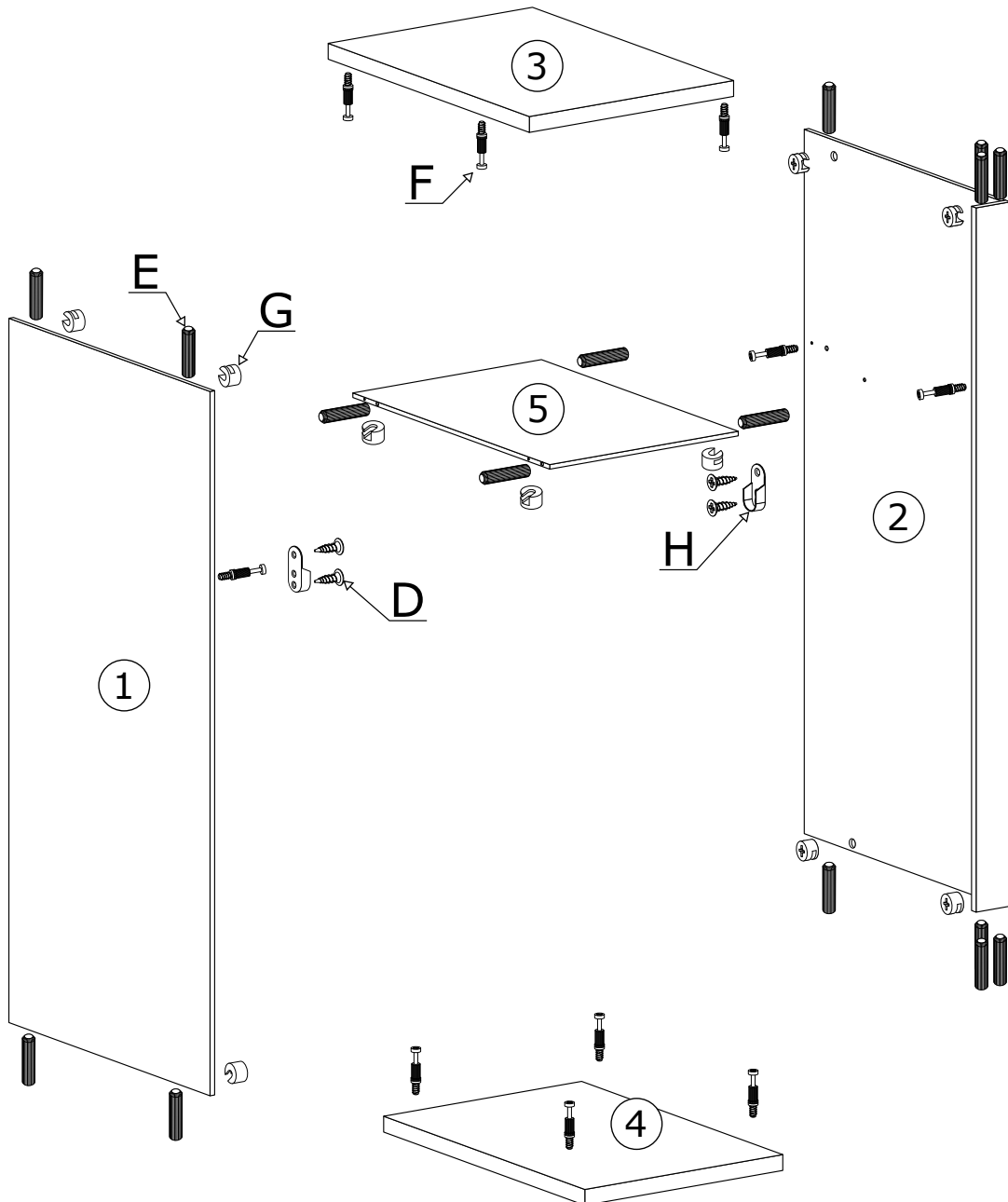

IV

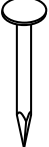
 x60

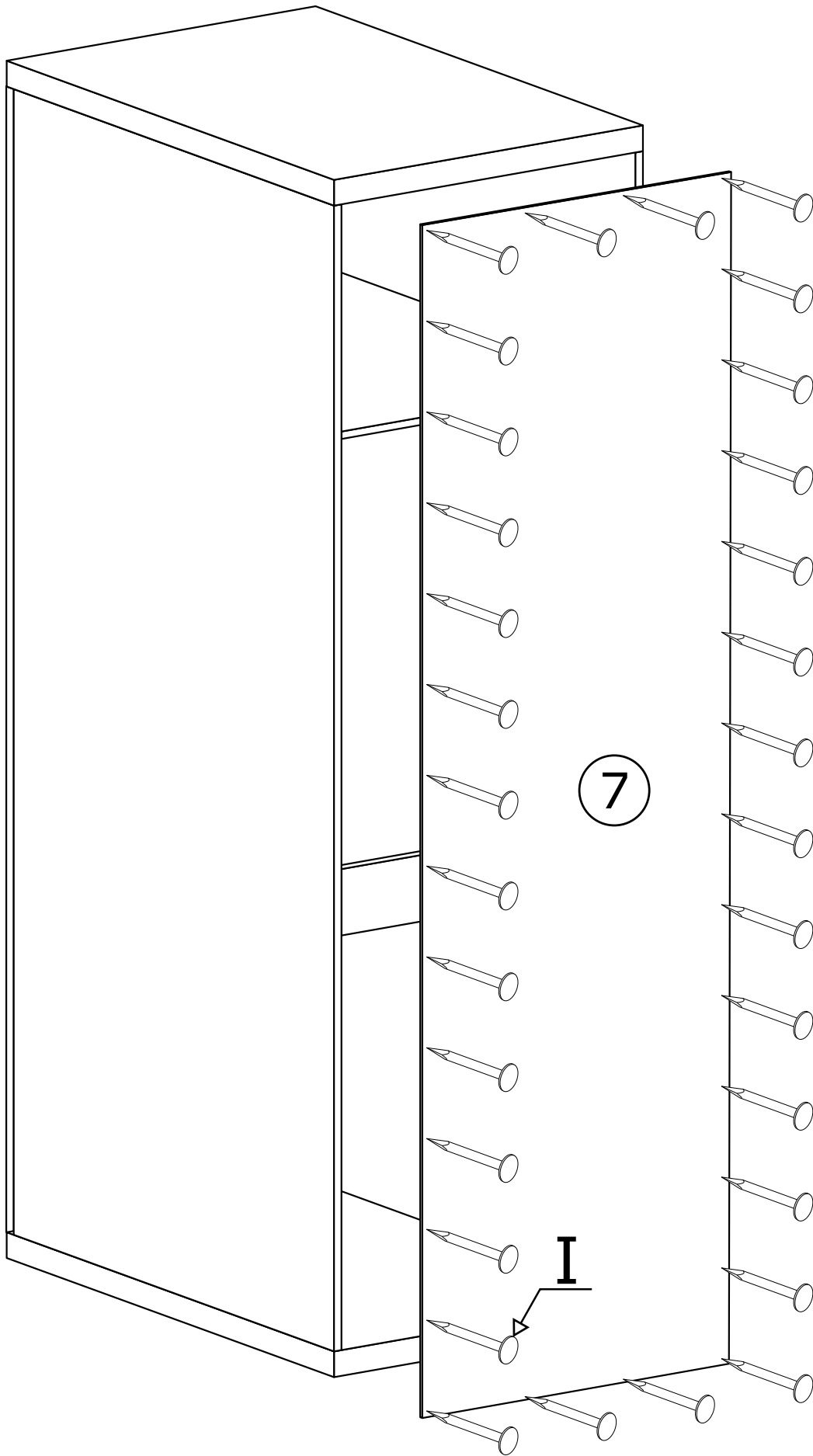

V

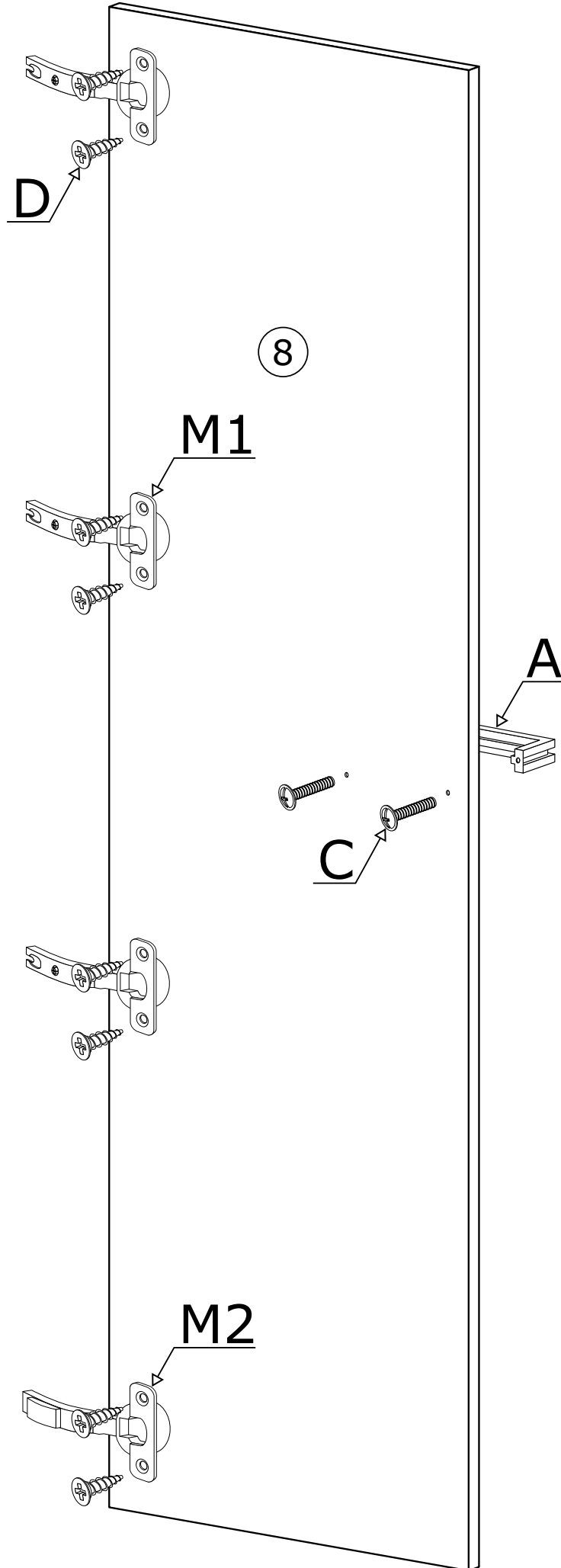

VI

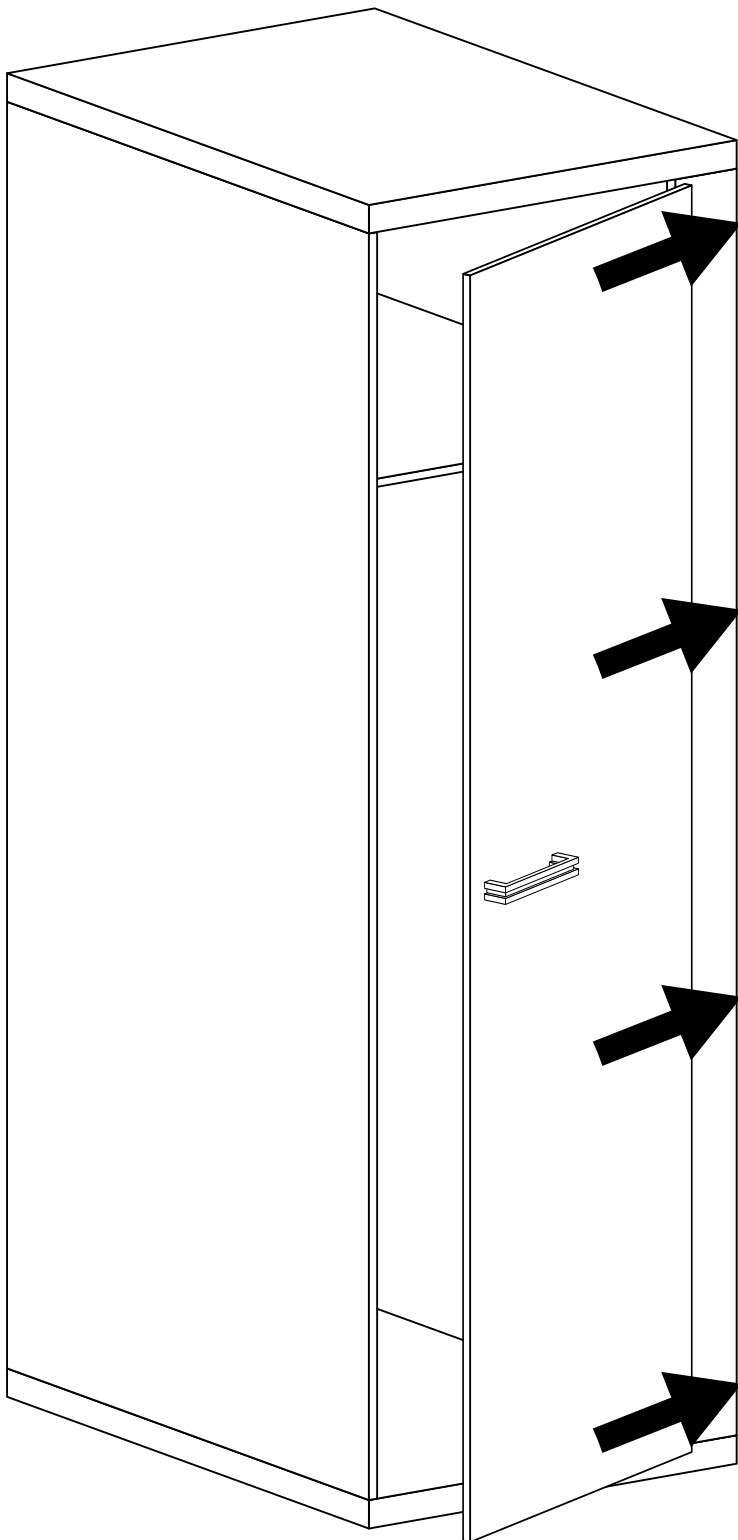
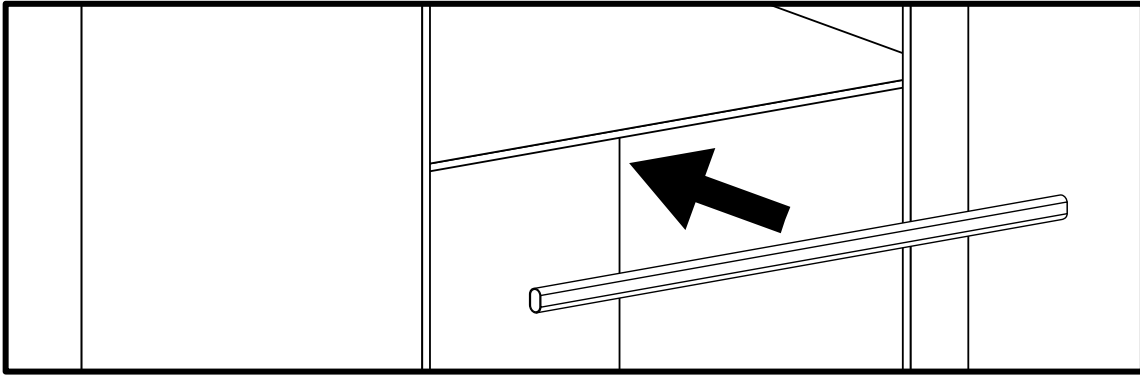

MONTAŻ KĄTOWNIKA

