

PARIS 11



Narzędzia potrzebne do montażu



UWAGA !!!

MONTOWANIE USZKODZONYCH
ELEMENTÓW POWODUJE UTRATĘ
GWARANCJI

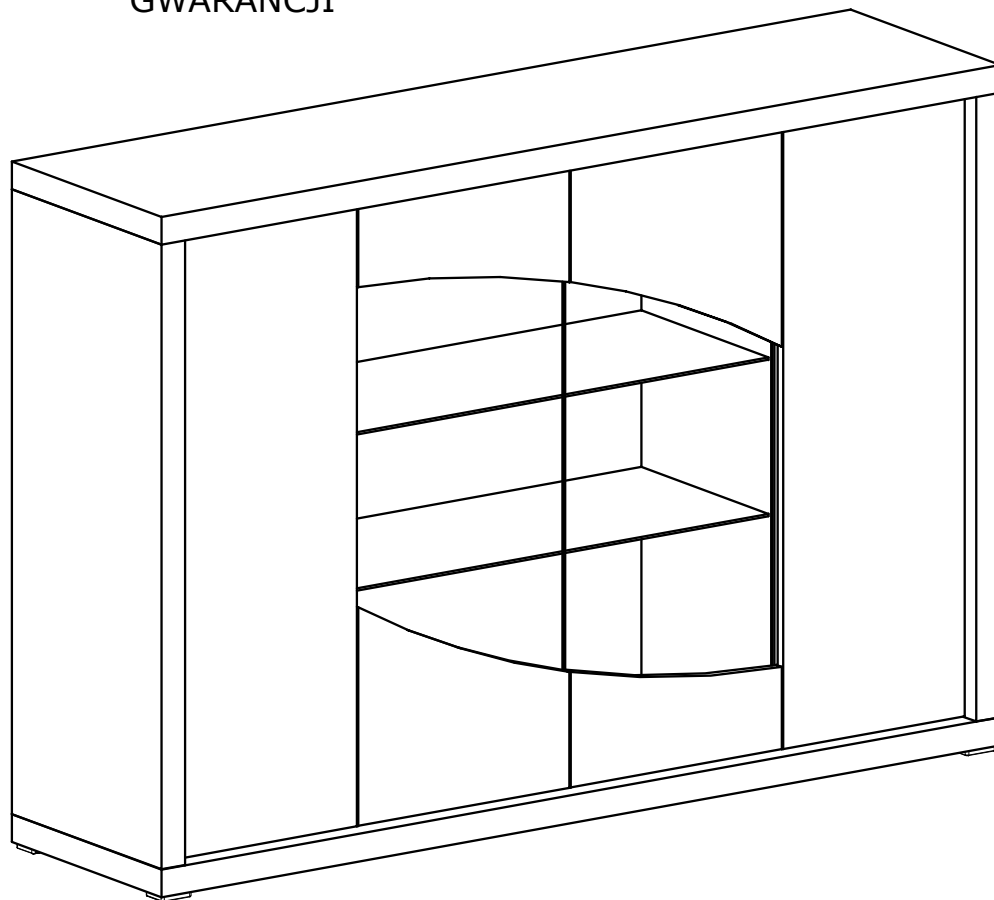

| Nr | D[mm] | S[mm] | G[mm] | Ilość |
|----|-------|-------|-------|-------|
| 1 | 1710 | 436 | 48 | 1 |
| 2 | 1710 | 436 | 48 | 1 |
| 3 | 1080 | 435 | 48 | 1 |
| 4 | 1080 | 388 | 16 | 1 |
| 5 | 1080 | 388 | 16 | 1 |
| 6 | 1080 | 435 | 48 | 1 |
| 7 | 395 | 312 | 16 | 4 |
| 8 | 850 | 370 | 4 | 2 |
| 9 | 1138 | 416 | 2,5 | 2 |
| 10 | 770 | 423 | 4 | 2 |
| 11 | 430 | 200 | 16 | 2 |
| 12 | 430 | 378 | 16 | 2 |
| 13 | 1074 | 370 | 16 | 1 |
| 14 | 1074 | 370 | 16 | 1 |
| 15 | 1138 | 864 | 2,5 | 1 |

W przypadku reklamacji proszę podać numer pakowacza znajdujący się na kartonie.



T - 14 St.

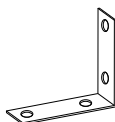

Y - 2 St.

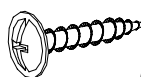

Q - 4 St.
3,5x16 mm



P - 16 St.



N - 12 St.
3,5x25 mm

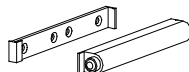

F - 4 St.

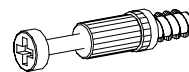

K - 16 St.



L - 16 St.

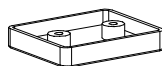

A - 6 St.

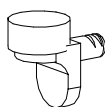

S - 10 St.

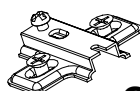

C - 8 St.

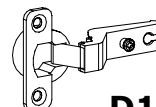

D1 - 4 St.

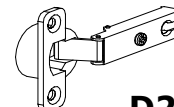

D2 - 4 St.



E - 80 St.



B - 16 St.



G - 56 St.
3,5x16 mm

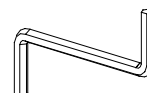

Z - 1 St.



R - 16 St.

I

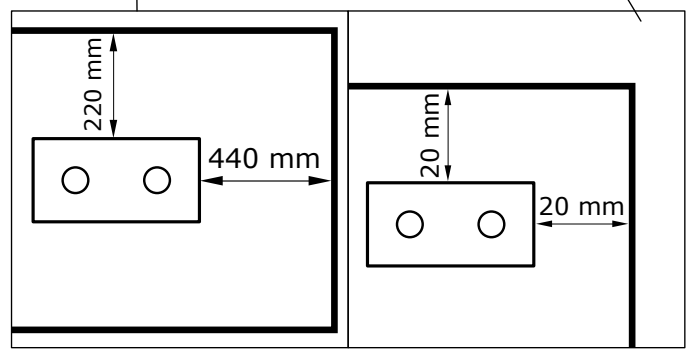
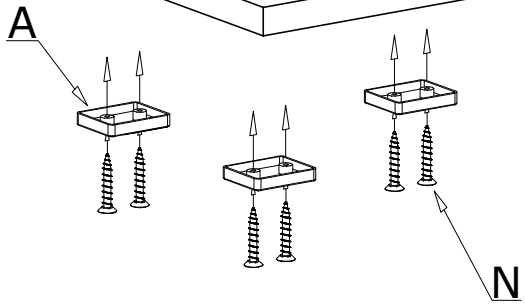
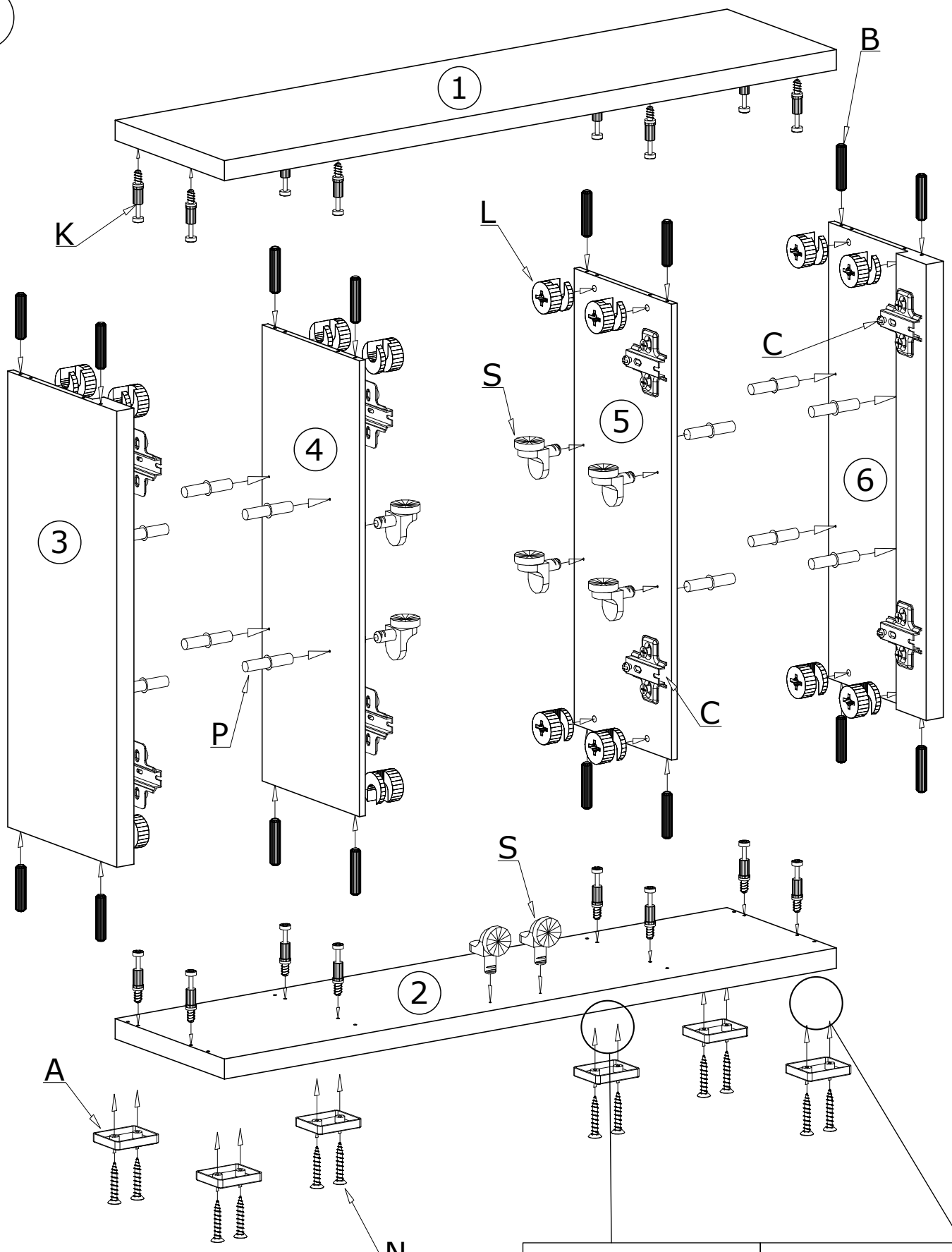

II

80X 

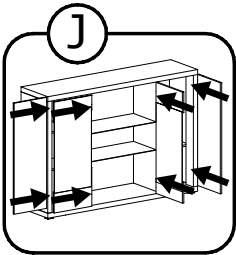
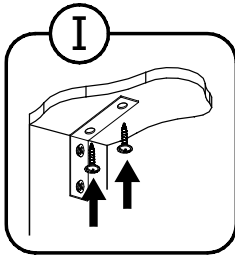
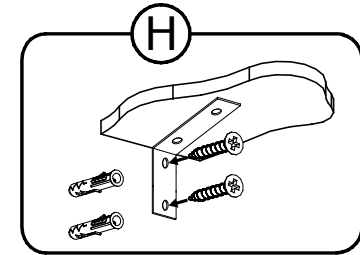
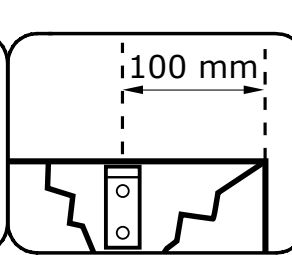
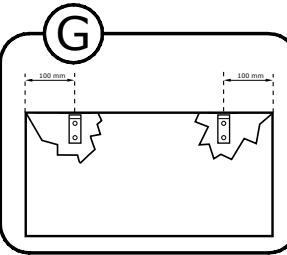
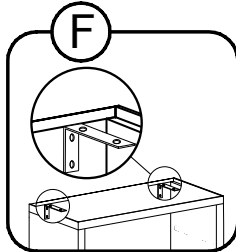
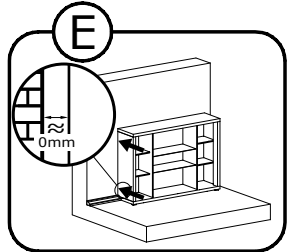
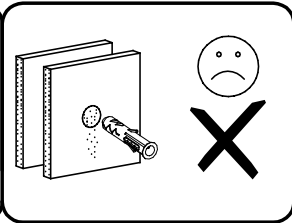
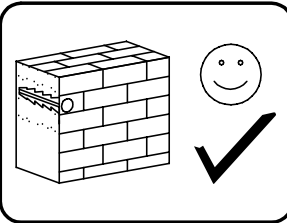
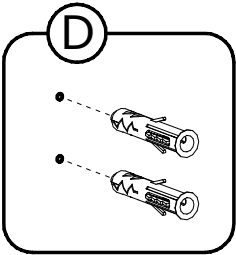
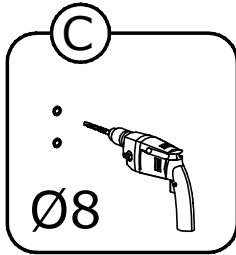
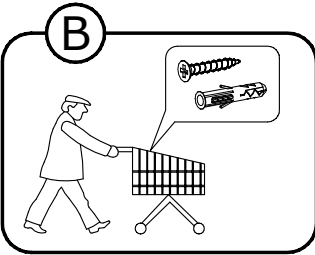
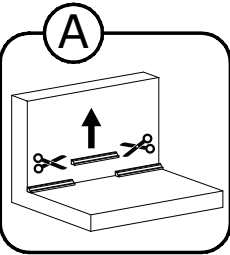
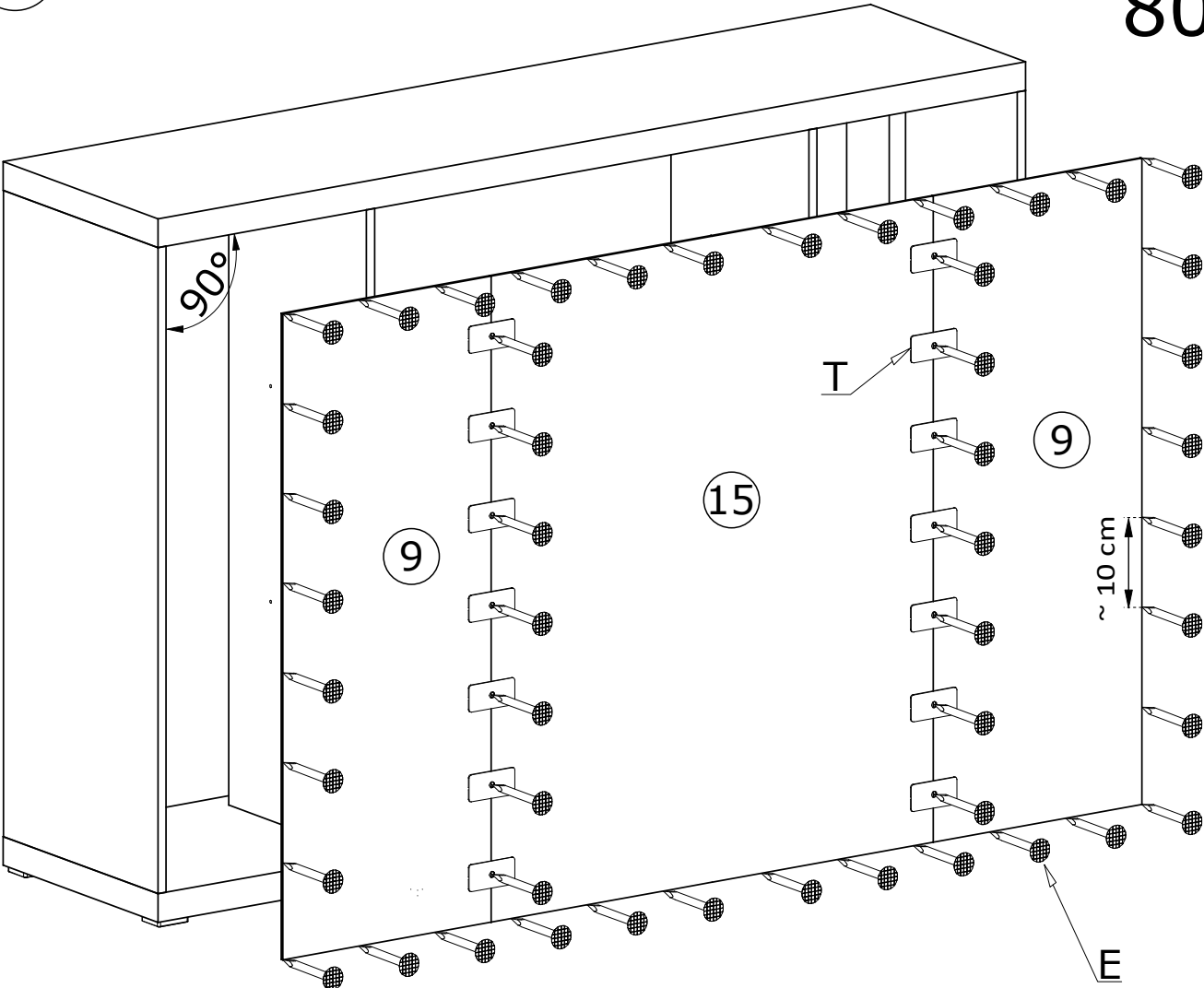

III

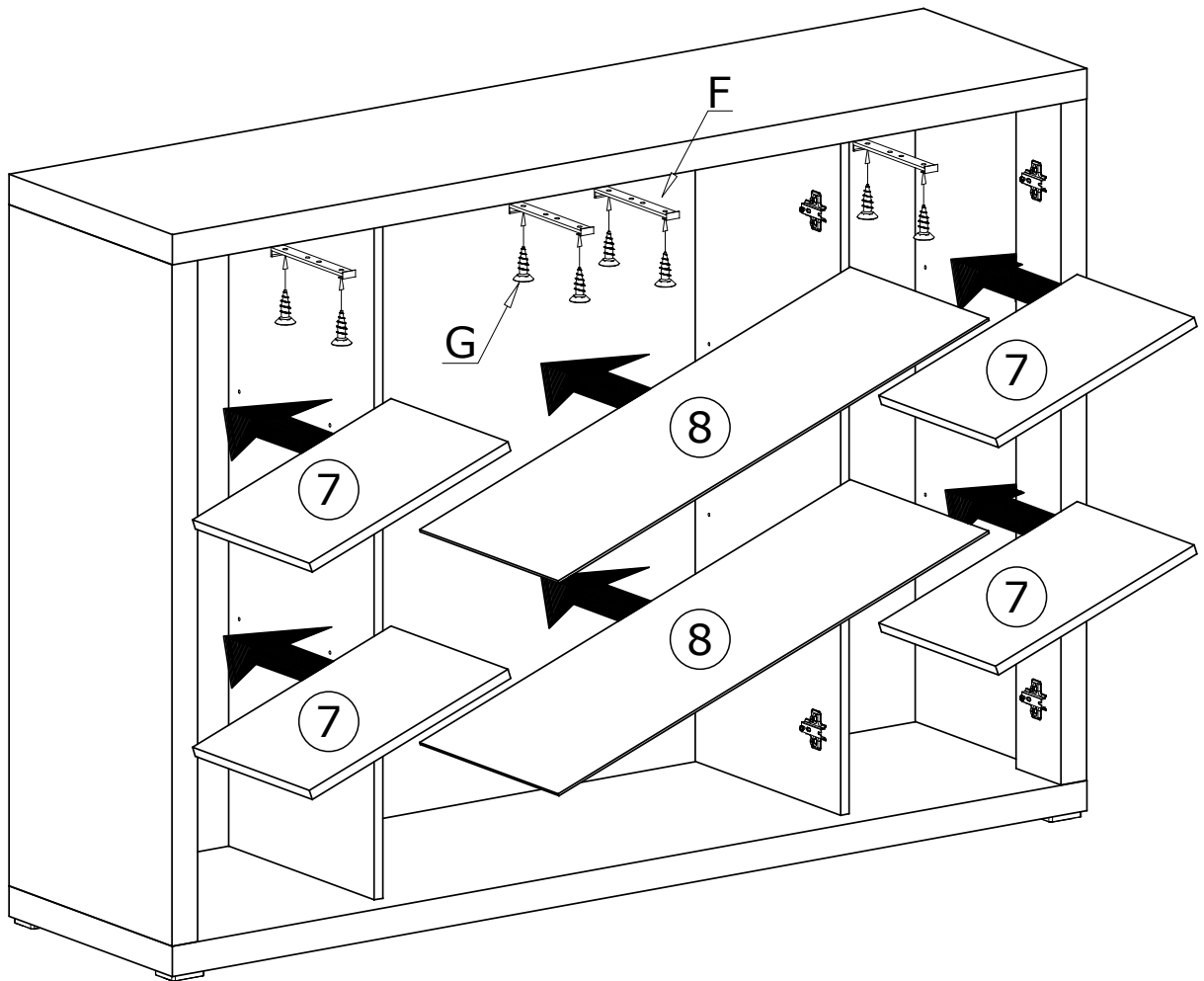

IV

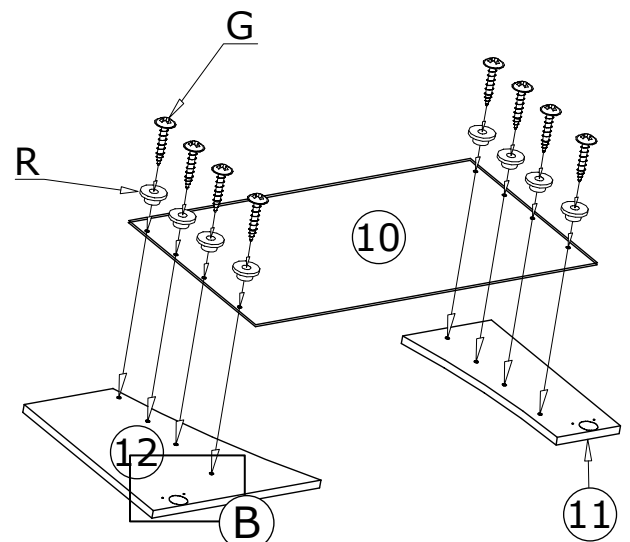
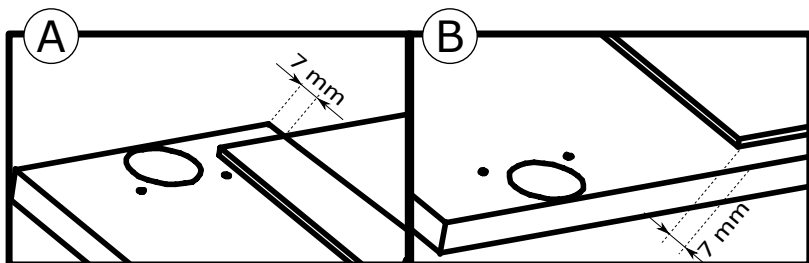
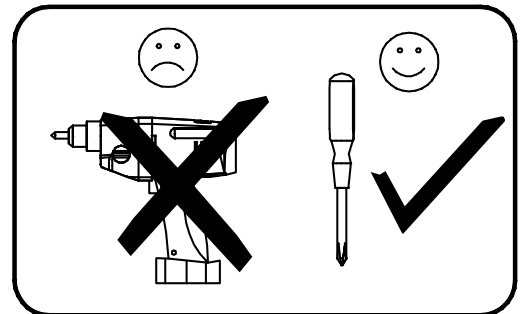
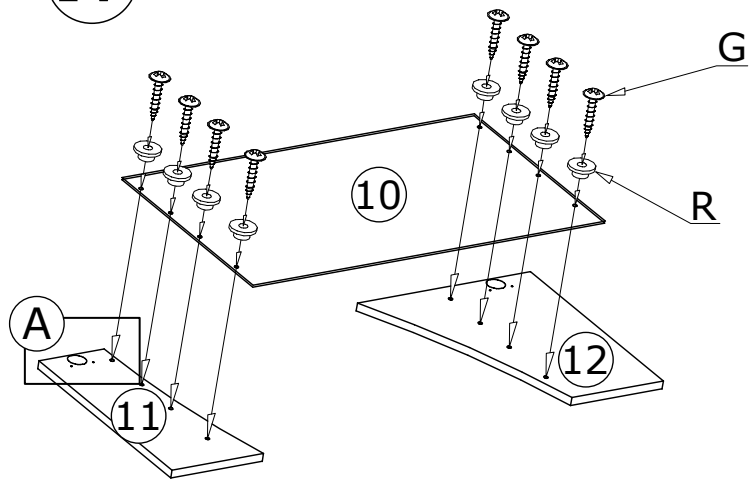

V

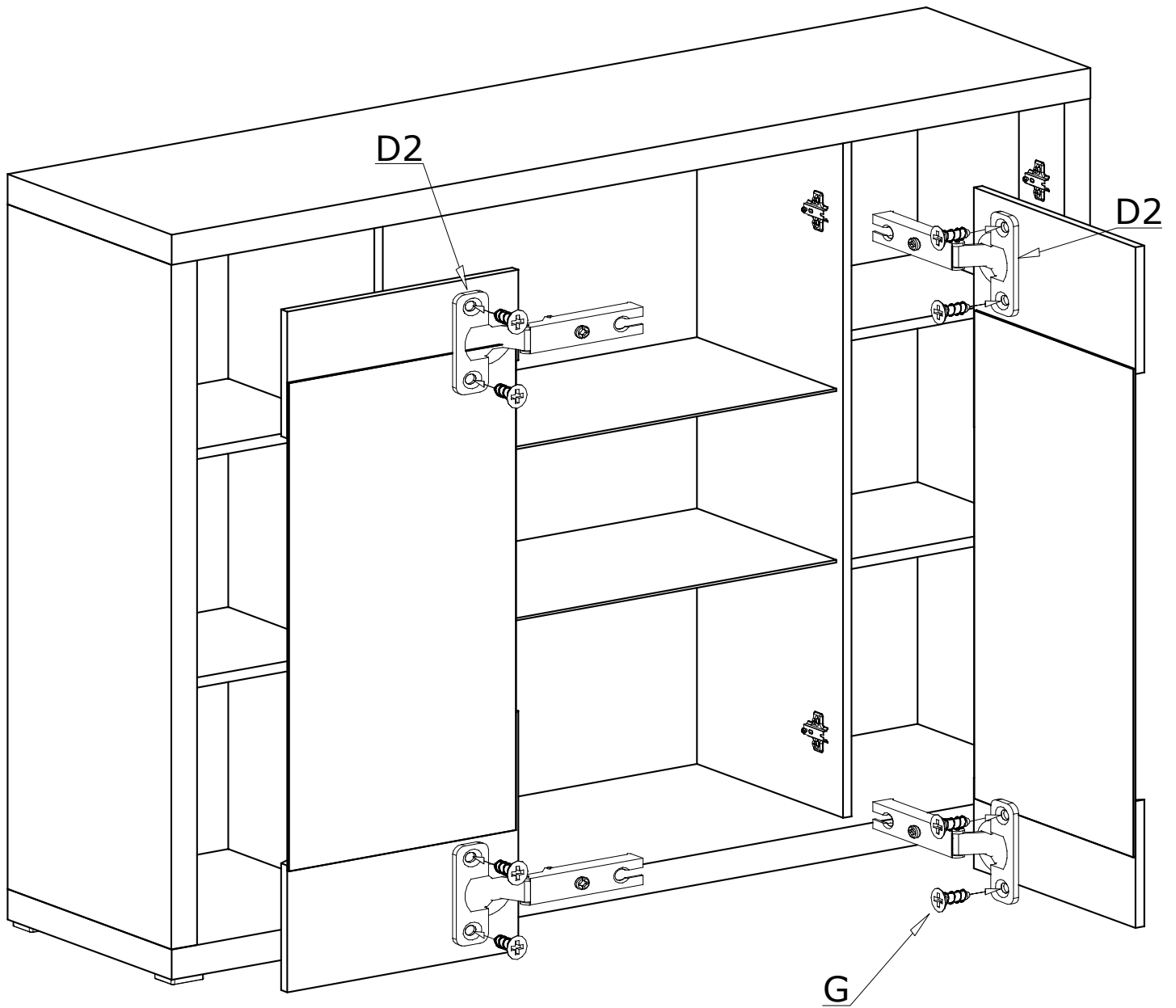

VI

